

### Features

- Compensation of axial, radial and angular misalignments
- Double engagement allows smooth torque transmission
- Deployable in horizontal and vertical applications
- Temperature range from -25° C to +100° C
- Low weight and low moments of inertia
- Maintenance free thanks to a combination of steel and polyamide 6.6
- Typical applications: Hydraulics, pump drives

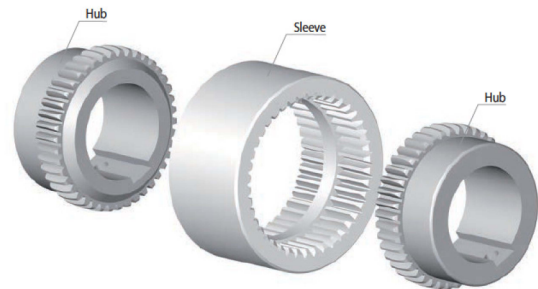
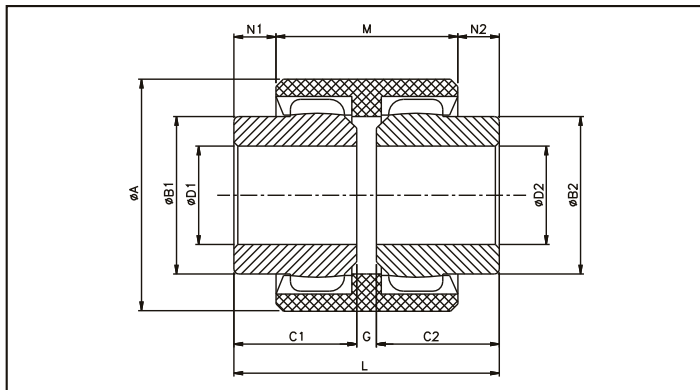

14-2

### TYPE - NS

All dimension in mm

Coupling Size	Rating at 100 rpm		Rated Torque (N-m)	Max. Speed rpm	Max. Bore (ø D1, ø D2) mm	ø A	ø B1, ø B2	C1, C2	G	M	N1, N2	Wt. in kg.	M.I. (WR <sup>2</sup> ) in kgm <sup>2</sup>	Maximum Misalignment		
	KW	HP												Axial ± mm	Radial ± mm	Angular #
NS - 14	0.10	0.13	10	14000	15	40	25	23	4	37	6.5	0.10	0.26	1	0.3	±1°
NS - 19	0.17	0.22	16	11800	20	48	32	25	4	37	8.5	0.23	0.47	1	0.3	±1°
NS - 24	0.21	0.28	20	10600	24	52	36	26	4	41	7.5	0.32	0.93	1	0.4	±1°
NS - 28	0.47	0.63	45	8500	28	66	44	40	4	46	19	0.74	3.09	1	0.4	±1°
NS - 32	0.63	0.84	60	7500	32	76	50	40	4	48	18	0.95	5.48	1	0.4	±1°
NS - 38	0.84	1.12	80	6700	38	83	58	40	4	48	18	1.23	8.68	1	0.4	±1°
NS - 42	1.00	1.34	100	6000	42	92	65	42	4	50	19	1.5	14.28	1	0.4	±1°
NS - 48	1.50	2.01	140	5600	48	95	68	50	4	50	27	1.81	18.34	1	0.4	±1°
NS - 65	4.00	5.36	380	4000	65	132	96	55	4	68	23	4.35	84.80	1	0.4	±1°

# ON EACH HUB

## B.V. Transmission Industries

Unit 18 , Khyati Industrial Estate,  
Laxmi Nagar, Link Road , Goregaon West,  
Mumbai - 400104, Maharashtra , India

Tel : +91- 22-28762345  
Tel : +91- 22-28767941  
☎ : +91- 93247 18035  
☎ : +91- 98206 92004

email :: sales@bvchains.com  
bvchain@gmail.com  
web:: www.bvchains.com  
web:: www.jawcouplings.com